

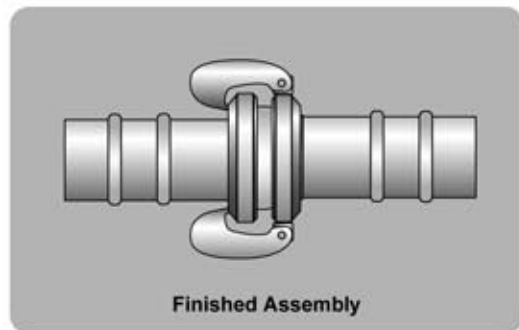

# Quick Coupling Assembly

## A-STYLE 10" & 12"

### Quick Coupling Components

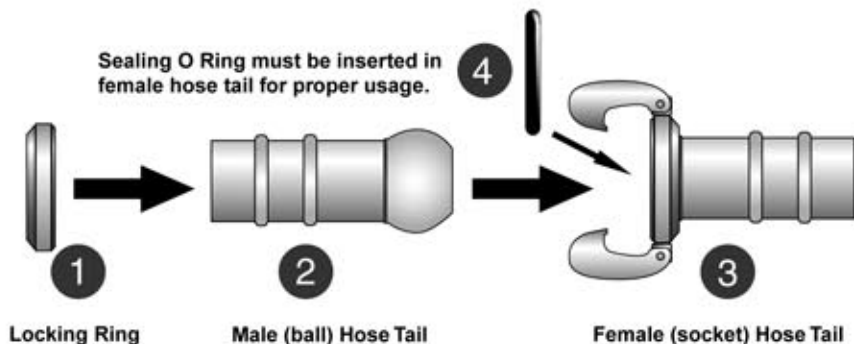

The Wil-loc A-Style Ball and Socket Coupling is a quick action coupling consisting of four components :

1. Locking Ring
2. Ball/ Male Fitting
3. Socket/ Female Fitting
4. Sealing O Ring

### Quick Coupling Assembly Procedure

*Before coupling new fittings, lightly lubricate the "O" Rings with a multipurpose, synthetic grease or a non-petroleum based rubber lubricant. This will extend the life of the "O" Ring and provide a smoother, easier coupling action to your Wil-loc fitting*

**Step 1:**  
Insert the ball into the socket so that the ball seats loosely against the O ring inside the socket.

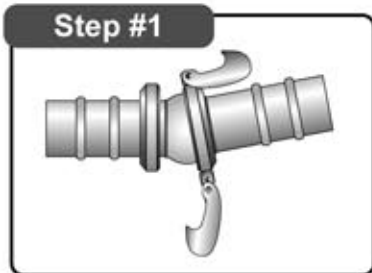

**Step 3:**  
While keeping tension on the "short" locking jaw so that it remains in place, extend the "long" locking jaw forward to reach behind the locking ring and seat the gripping edge securely into the grooved lip.

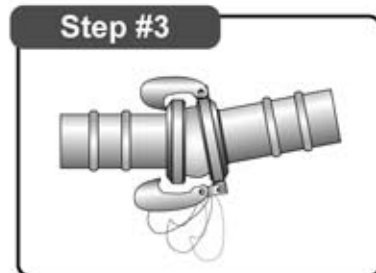

**Step 2:**  
Reach around the locking ring with the "short" locking jaw and seat its gripping edge securely into the grooved lip on the back side of the locking ring.

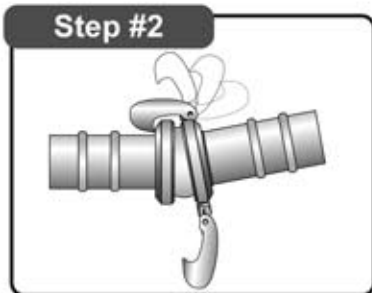

**Step 4\*:**  
Finally, ensure that the leading edge of the ball is aligned just enough so that it does not cut into the O ring surface, then (with 12" fittings) insert the leverage bar into the hole provided on the base of the "long" jaw and pull back toward the barbed shank to lock the ball into the socket.

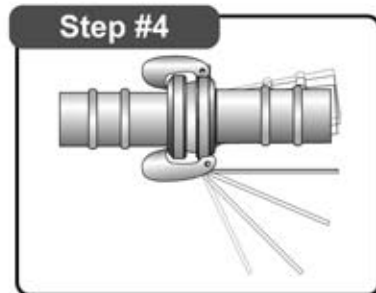

**\*NOTE:** 10" A-Style Wil-loc female/socket fittings have lever locking handles permanently attached to the "long" jaw mechanism. Locking action is similar to the B-Style lever arm.

For additional information about the assembly or use of your Wil-loc® Quick Coupling products contact customer service at 1-800- 801-0123.